



155 Gaston Bridge Road

Shepperton, TW17 8HB

Asking price £525,000



Offered to the market for the first time in over 50 years and with no onward chain, is this spacious four-bedroom 1950s family home.

Benefitting from a double-storey extension, there is flexible accommodation over two floors. The ground floor consists of a large dual-aspect reception room and the original living room which accesses a dining area overlooking the rear garden. The fitted kitchen leads to a conservatory area which has access to the garden. The ground floor is completed with a guest cloakroom.

The first floor provides four well-proportioned bedrooms, we don't think you will find a bigger master bedroom! It is a fantastic size and has an en-suite bathroom. There is a further family bathroom on the first floor with separate wc.

The property has been well maintained by the current owners and the wood-block flooring and mid-20th century fireplace are particularly noteworthy.

With a private garden to the rear and a garage in a nearby block, this makes a wonderful family home, as the current family can confirm. It is now time for a new family to make this their home and create their own memories.





Floor Plan

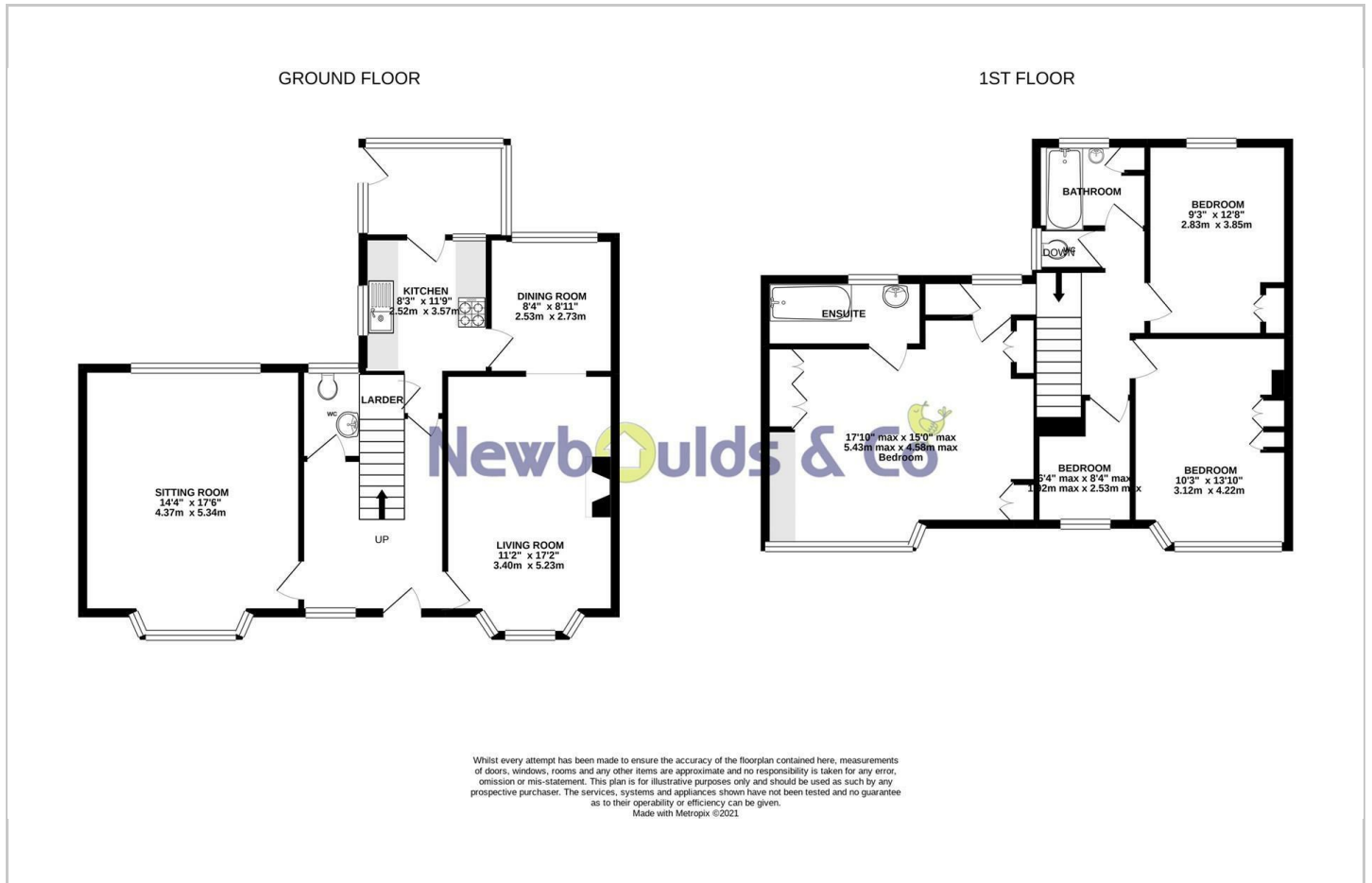

Area Map



Energy Efficiency Graph

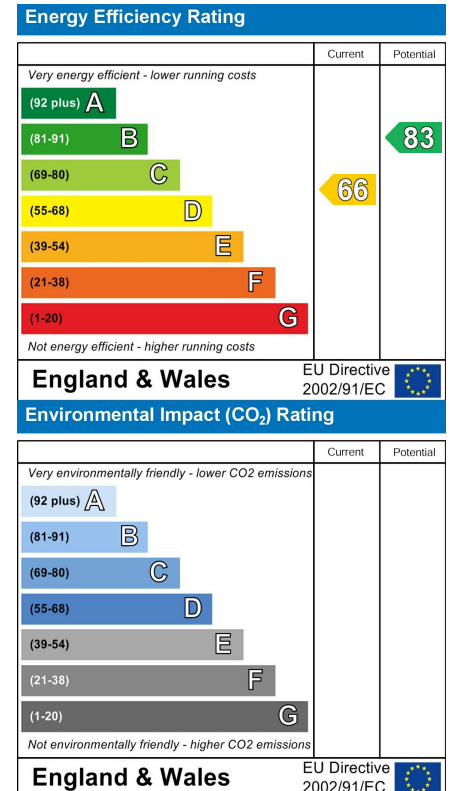

Viewing

Please contact our Shepperton - Sales Office on 01932232927 if you wish to arrange a viewing appointment for this property or require further information.

These particulars, whilst believed to be accurate are set out as a general outline only for guidance and do not constitute any part of an offer or contract. Intending purchasers should not rely on them as statements of representation of fact, but must satisfy themselves by inspection or otherwise as to their accuracy. No person in this firm's employment has the authority to make or give any representation or warranty in respect of the property.